

6. USER INFORMATION

Protect your Home Against Fire

Contact your local Fire Brigade for a home safety check, this information is free and will identify potential fire hazards in and around your home.

Make sure all occupants of the home know what a fire alarm sounds like. Prove and practice a fire escape plan and arrange a suitable and safe assembly point.

What to Do if the Alarms Sound

Alarms sounds are as follows:

Full alarm indicating smoke and fire	Repeating series of 3 beeps every 4 seconds with flashing light	••• ••• ••••••
Low Battery	Single beep every minute	• • • •
Test button jammed	One beep every 11 seconds	• • • •
Fault	Double beep every minute	•• •• •• ••

WARNING: Do not store alarms in temperatures below 5 degrees and above 30 degrees, and in low humidity; this may cause beeping and nuisance alarms when first installed. These will clear after a short time when the alarm has become acclimatised. Extended periods under these conditions will reduce the life of the alarms and invalidate the warranty.

MANY CHILDREN MAY NOT RESPOND TO THE ALARM TONES. THEREFORE CHILDREN MUST NOT BE LEFT ON THEIR OWN BUT MUST BE SUPERVISED AND IN THE EVENT OF A FIRE BE BROUGHT TO SAFETY BY AN ADULT.

In the event of an alarm sounding ensure everyone leaves the building as soon as possible.

- Do not run.
- Do not stop to collect belongings.
- If it is safe to do so, close all windows and doors as you escape to prevent the spread of fire.
- Smoke is the main cause of death from fire. If trapped inside the building, cover your mouth, conserve breath and crawl to safety.

Do not silence a fire alarm until you know the cause of the alarm and when all occupants are safely outside the building. The light on the alarm will be flashing Red once every second.

7. ALARM MAINTENANCE

A regular program of fire alarm maintenance will help to keep your alarm in good working order.

- Test the alarm monthly making sure that it remains operational.
- Vacuum the alarm every six months and wipe with a damp cloth.
- Do not paint the alarm.

A smoke alarm is a sensitive life-saving device. The life of this alarm can be significantly reduced by adverse environments, incorrect location and a failure to regularly clean and maintain it according to the instructions. Incorrect location and a lack of reasonable care may also cause it to malfunction and will invalidate the warranty.

8. TROUBLE SHOOTING

The battery will last the lifetime of the device and is not replaceable. At the end of its life the alarm will beep once every minute for a minimum of one month. The life of the battery can be significantly shortened by periods of storage or use in temperatures below 5°C or above 30°C. It will also be shortened by frequent or extended periods in full alarm often caused by conditions such as cigarette smoke, steam, aerosol spray and condensation. In these circumstances the warranty will be void. If this happens at night you can press the test button to silence the battery warning for 10 hours. Replace the alarm as soon as possible.

Problems are indicated in five ways:

1. The alarm beeps twice every minute indicating a malfunction.
2. The alarm beeps once every minute indicating a low battery.
3. The full alarm sounds for no reason. (A repeating series of three beeps with flashing light)
4. The alarm does not sound when pressing the test button.
5. The red light remains steadily on or off. (i.e. does not flash approximately once every minute, when the unit is not in alarm).

Inspect for obvious damage. Check that the alarm has been installed in accordance with the instructions. In the case of repeated nuisance alarms, vacuum thoroughly to ensure it is free from dust, cobwebs and external contamination from such things as cigarette smoke, drying paint, spray from household aerosols and steam that will ultimately shorten the life of the alarm and invalidate the warranty.

If this does not correct the problem, do NOT attempt to repair. There are no user serviceable parts inside. If the smoke alarm is within the warranty period and terms, indicate the nature of the problem and return the unit with proof of purchase to the address at the end of this manual. Units beyond warranty cannot be economically repaired.

9. PRODUCT WARRANTY

Newfield Group guarantees to you, as a purchaser, that the enclosed fire alarm will be free from defects in material, workmanship or design under normal use and service for a period of 10-Years.

This Guarantee is not assignable. Our liability to you, under this guarantee is limited to repairing or replacing any part which we find to be defective in material, workmanship or design, free of charge to the customer, upon sending the alarm with proof of date of purchase, postage paid to Newfield Group Ltd, 491 Waterloo Road, Christchurch 8042. The terms of this guarantee will not apply in the following circumstances: If the alarm has been modified, dismantled, contaminated, damaged, neglected or otherwise abused or altered following the date of purchase, or if it fails to operate due to incorrect siting, installation, maintenance, or damage caused by failure to abide by the instructions supplied. It is specifically drawn to the users attention that substantial periods in alarm will shorten alarm life, during which time the fire alarm will have provided valuable protection; no Claim under the guarantee will be entertained.

The liability of Newfield Group Ltd, arising from the sale of this alarm or under the terms of this guarantee shall not in any case exceed the cost of replacement of the alarm. In no case, shall Newfield Group Ltd be liable for consequential loss or damage resulting from the failure of the alarm or the breach of this or any other guarantee, express or implied or for damage caused by failure to abide by the instructions supplied.

This guarantee does not affect your statutory rights.



Distributed in NZ by
Newfield Group Ltd

www.orcasafety.co.nz

ORCA[®]

You're in Safe Hands

Micro Smoke & Heat Alarm



USER GUIDE

Model: OM200L

1. PRODUCT OVERVIEW

The Orca OM200L Micro Smoke Alarm is approved to the most recent and rigorous standards. Featuring a high performance X-Profile sensing chamber it is approved to EN14604: 2005 and is particularly sensitive to slow smouldering fires typically originating in living rooms, bedrooms and hallways, whilst being highly resistant to nuisance alarms.

In addition, the alarm incorporates a heat sensor designed to provide early detection of hot fast-flaming fires.

The alarm and sealed-in battery are guaranteed for the 10-Year life of the product, including routine weekly testing. However, it's life can be significantly reduced by adverse environments, incorrect location, and a failure to regularly clean and maintain it according to the following instructions. Incorrect location and a lack of reasonable care may also cause it to malfunction and will invalidate the warranty.

Product Features

- Sealed in 10-year lifetime Battery.
- Approved to EN14604:2005. Smoke alarm devices.
- Unique X-Profile detection chamber with insect screen.
- Internal heat sensor activates at approximately 62° C.
- Bespoke software maximises detection ability, false alarm rejection and Alarm Silence operation.
- Power switch on - red light flashes approximately every minute confirming unit is receiving power and ready to detect fire conditions. (Quiescent Mode)
- Low Battery Warning - alarm gives one beep every minute with three flashes of the red light every eight seconds.
- Low Battery Warning Silence - Low battery warnings often start at night. Silence the audible warning for ten hours by pressing the test button, thus avoiding removing the alarm from its mounting plate. (The red light will flash three times every eight seconds during this period). The batteries can then be replaced when convenient the following day.
- Full Face Test Button tests sensitivity, circuitry, battery, and alarm sounder.
- Loud 85 Decibel Piezo Electric Alarm – Automatically resets when hazardous condition has passed, and chamber is clear.
- Alarm Silence - Silence your smoke alarm by momentarily pressing the test button. Ideal in nonemergency situations where nuisance alarms may have been created, for example, by steam. The red light flashes every 8 seconds to remind you that the smoke alarm has been silenced and will automatically reset to quiescent mode in 10 minutes.



2. CHOICE AND LOCATION OF ALARMS

Photoelectric Smoke Alarms are best at detecting smouldering fires such as those started in electrical equipment, clothing and soft furnishings such as seating, bedding, curtains and carpets,. They are, therefore, ideally suited for living rooms, bedrooms and escape routes in domestic accommodation.

They are not recommended in kitchens, laundries, workshops and garages where dust, dirt and moisture contribute to nuisance alarms in smoke alarms.

For minimum protection, install at least one smoke alarm on each level of your home. They should be installed in hallways, corridors and all escape routes from the building and within 3 meters of all bedroom doors. All alarms should be interconnected.

Recommended siting of smoke and heat alarms in:

SINGLE STOREY HOME WITH TWO SLEEPING AREAS

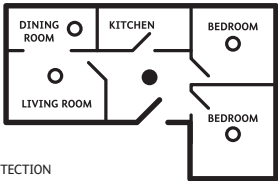

- SMOKE ALARMS FOR MINIMUM PROTECTION
- SMOKE ALARMS FOR INCREASED PROTECTION

MULTIPLE STOREY HOME WITH MULTIPLE SLEEPING AREAS

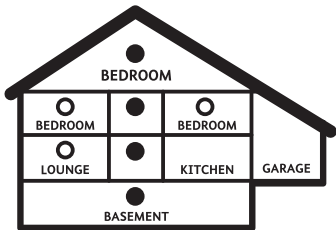

Recommended position of alarms in a room, corridor or escape route:

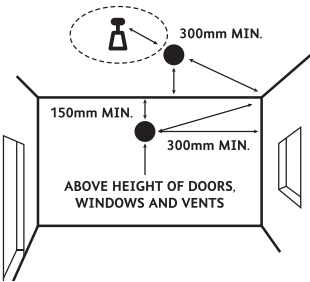

Recommended position of alarms on apex ceilings:



NB: Ceiling location is preferable to walls.

3. AVOID THE FOLLOWING LOCATIONS

The life of this alarm can be significantly reduced by adverse environments, incorrect location, and a failure to regularly clean and maintain it according to the following instructions. Incorrect location and a lack of reasonable care may also cause it to malfunction and will invalidate the warranty.

1. Do not locate near fans or extractors. These can pull smoke and heat away from the alarms.
2. Do not install in or near high humidity areas such as showers, bathrooms or kitchens where humidity levels exceed 85% or the room temperature exceeds 40° C or falls below 0° C. These may cause nuisance alarms and damage the detector.
3. Do not install in the peak of an “A” frame or sloping ceiling. This may delay smoke and heat reaching them due to the presence of dead air.
4. Do not install less than 300mm from walls and light fittings when mounted on the ceiling where heat and dead air may prevent smoke reaching the alarm.
5. Do not install in insect infested areas.
6. Do not install in areas subjected to heavy concentrations of cigarette smoke that will cause nuisance alarms and the alarm to become contaminated.
7. Do not install smoke alarms in kitchens, boiler rooms and garages where fumes and dust may cause nuisance alarms.
8. Do not install on poorly insulated walls and ceilings where cold air boundary layers could prevent smoke reaching the alarm.
9. Do not install near objects that could prevent smoke and heat reaching the alarm.
10. Do not install within 1500mm of fluorescent light fitting that could trigger nuisance alarms.
11. Do not paint the alarm.

The location of the alarms must be in accordance with applicable building regulations.

4. FURTHER DETAIL ON ALARM LOCATION

1. At least one smoke alarm should be installed in the escape route on all floors of the building.
2. Smoke alarms should be at least 300mm from any wall or light fitting.
3. If ceiling mounting is impractical smoke alarms may be installed on walls provided that the area is no longer or wider than 10 meters and the total area does not exceed 50m2 and that: -
 - a. The smoke alarm is between 150mm and 300mm below the ceiling.
 - b. The smoke alarm is located higher than openings such as vents, doors and opening windows.
 - c. They are not mounted close to or above heaters or air-conditioning vents.
4. Where smoke alarms are located in a hallway, corridor or landing, the alarm should be no further than three meters from any bedroom door to assist audibility behind closed doors.
5. No point on the ceiling in any room, hallway or corridor should be further than 7.5 meters from any smoke alarm.
6. To give the earliest warning of a developing fire, smoke alarms should be installed in all the rooms of your home.

5. INSTALLATION PROCEDURE

Do not store alarms in temperatures below 5° C or above 30° C; this may cause beeping and nuisance alarms when first installed. These will clear after a short time when the alarm has become acclimatised. Extended periods under these conditions will reduce the life of the alarms and invalidate the warranty.

Select desired location, refer to the section above. You need to ensure surfaces do not contain hazardous materials e.g. asbestos. Screw fittings are suitable for use on wood, plaster and plasterboard but on other surfaces such as concrete adhesive material or the adhesive pad may be better. For certain applications, the installer may need to source own fixings. Screw the mounting base to ceiling using the fixings provided. You may also use the integrated self-adhesive pad. When using the pad make sure the surface is flake free, clean, dry and flat.

Take care to use all appropriate Health and Safety precautions when fixing the mounting plate and alarm to their surface - in particular use appropriate access equipment, protect yourself from dust and wear eye protection .

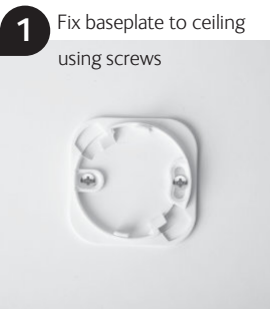

Auto-power On
Once smoke alarm is aligned with the base plate, the alarm automatically powers on.

Testing the Alarm

Press and release the test button to test the alarm. The alarm should sound three times with a flashing red light then stop. After testing check that the red-light flashes approximately every minute. Test the alarm once a week to ensure correct operation.

WARNING: The electronic test button provides a full test of the alarms functionality. Do not try to test the alarm using either heat smoke or naked flame as damage will occur.

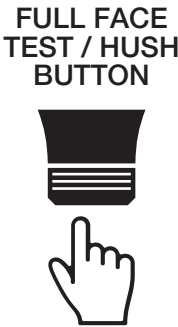

Push to activate